

**STEPS TO USE WRIST BAND HOLDER**

2 lbs



Open the velcro fixed wrist band and pass your hand within the loop of the band.

Now snugly wrap the wrist band on your hand with the help of velcro.

For adding additional tool to your wrist band attach the spring lanyard to the D-ring of the wrist band.

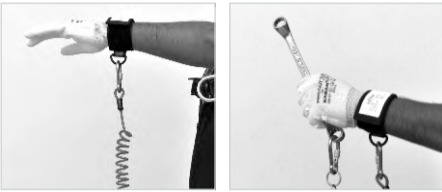

Connect the carabiner of the spring lanyard to the d-ring of wrist band holder.

Now the wrist band holder is ready to use.

**STEPS TO USE V-RING ATTACHMENT**

35 lbs

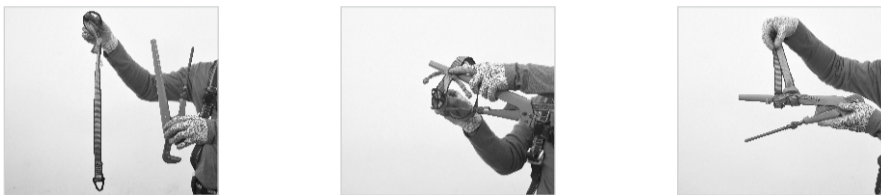

Untangle the tool lanyard and pass the loop at the other end through the desired tool.

Now cinch the loop over the tool and tightly wrap the two wings of the tool lanyard over the tool for strong hold grip on the tool.

Stretch the webbing of the tool lanyard for making a tight knot on the tool.

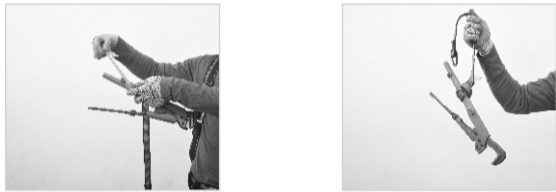

Tightly wrap the tool tape around the lanyard knot for tight grip and strong stable fix of the knot on the tool.

Now the V-ring tool lanyard is ready to use.

4



**LIFESPAN:** The estimated product Lifespan is depends if the product passes the preuse inspection and periodic inspection by a competent person. The following factors can reduce the Lifespan of the product: intense use, contact with chemical substances, especially aggressive environments, extreme temperature exposure, UV exposure, abrasions, cuts, violent impacts, bad use or maintenance.

**DISCLAIMER:** Prior to use the end user must read and understand the manufacturer's instructions supplied with this product at the time of shipment and seek training from their employer's trained personnel on the proper usage of the product. Manufacturer is not liable or responsible for any loss, damage or injury caused or incurred by any person on grounds of improper usage or installation of this product.

**PRODUCT LABELS-**

Product label has the following information:

- I- Manufacturer's Logo
- II- Product Category
- III- Product Name
- IV- Model Number
- V- Material of construction

- VI- Relevant Standards
- VII- Serial Number
- VIII- Batch Number
- IX- Date of Manufacturing
- X- Load Capacity of Lanyard
- XI- Relaxed Tether Length

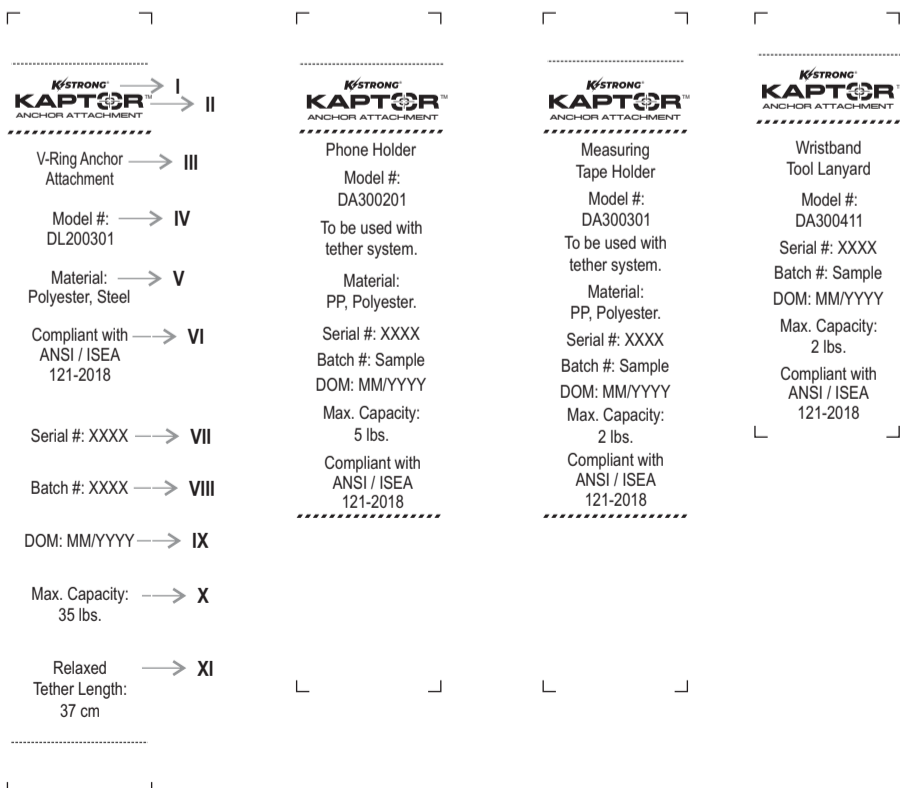

6



**DOs AND DON'Ts**

- ✓ The user must weigh the tool or tools to be tethered to ensure they do not exceed the maximum safe working capacity of the tool lanyard or any part of your tethering system. User should also refer to the label or user manual for information on maximum capacity information.
- ✓ Always inspect tool lanyards and all parts of your tethering system prior to, and after each use (refer to inspection steps).
- ✓ Use extra precaution around moving machinery or parts, electrical hazards, chemical hazards or other apparent hazards.
- ✓ Always wear appropriate personal protective equipment when installing or using tethering systems.
- ✓ Always ensure the carabiners are closed and locked properly.
- ✓ Always ensure the hook & loop closures fasten properly.
- ✗ Tool and lanyards are for tool use only. They are not for human support, nor are they intended to be part of a human fall protection system.
- ✗ For tools weighing more than 5lbs. (2.26kg), do not tether such tools to the human body unless specifically authorized per the product instructions.
- ✗ Do not wrap lanyards around sharp or rough edges.
- ✗ Never modify or alter tool lanyards.
- ✗ Never modify a tool or primary anchoring location.
- ✗ Never tie knots in a tool lanyard.
- ✗ Never wrap the lanyard back onto itself, unless specifically instructed.
- ✗ Never connect multiple lanyards together.
- ✗ Do not use this product if it interferes with the tool's safe working condition, or the anchoring location—including personal fall protection.
- ✗ Lanyards must not be used as hoisting taglines or used to statically suspend tools and equipment.
- ✗ Never cinch the cord or carabiner around the wrist.
- ✗ If you are not able to find a suitable connection point on the tool, do not connect the Tether. Ask your supervisor for help.

When using Retrofit Tool or Anchor Attachments, the user must ensure that the Maximum Tether Length identified on the attachments is compatible with the identified tether length indicated on the tool lanyard label. Failure in doing so may not give optimum utilization of the connection made

**INSPECTION:**

- A visual inspection is essential before using any KStrong equipment.
- Before each use, make sure you find no signs of cuts, wear, discoloration, deformation, corrosion, etc. When in doubt, the equipment should be replaced.
- Do not use this equipment beyond its weight limit.
- Always check the connection to the tool before each use.
- Tool Lanyards that have been used to arrest a falling tool should be taken out of service.

**MAINTENANCE AND CLEANING**

- Proper care is important for maintaining the safety and longevity of the tool lanyards. Before and after each use, remove all dirt, corrosives, and other contaminants from the KStrong Tool Lanyards.
- Do not wrap lanyards around sharp or rough edges. Lanyards should not be used with blades, knives, etc.
- If the KStrong Tool Lanyards cannot be cleaned with plain water, use mild soap and water, then rinse and wipe dry, or allow to dry in an environment absent of excessive heat and light.

**STORAGE AND TRANSPORTATION**

- When not in use, store equipment where it will not be affected by heat, light, excessive moisture, chemicals, or other corrosive elements.
- The product should be kept and transported in its original packaging or in airtight packaging.

**DISPOSAL**

Steps to dispose tool lanyards when deemed unfit for use:

- Spread the tool lanyard on a table / flat surface.
- Inspect the wear and tear present on the tool lanyard.
- If any wear and tear is observed, dispose the lanyard using a sharp scissors; first cut the Textile and dismantle the tool lanyard.

**WARNING**  
After every use or if the tool lanyard has arrested a tool fall, the tool lanyard should be checked by a competent person. If deemed not fit for use, it should be immediately removed from use.

**NOTE**

Do not attempt to disassemble the unit or make repairs to the equipment. Send the equipment back to the manufacturer, or persons or entities authorized in writing by the manufacturer to make repairs to the equipment.

5



**WARNING!** Whatever combination you use, make sure that it does not interfere with the safe use of your tool.

EQUIPMENT RECORD				
Product				
Model & type/identification		Trade Name	Identification number	
Manufacturer		Address	Tel, fax, email into use	
Year of manufacture		Purchase Date	Date first put into use	
Other relevant information (e.g. document number)				
PERIODIC EXAMINATION AND REPAIR HISTORY				
Date	Reason for entry (periodic examination or repair)	Defects noted, repairs carried out and other relevant information	Name and signature of competent person	Periodic examination next due date

7



# KAPTOR™ ANCHOR ATTACHMENTS

## DROP PREVENTION RANGE

THESE INSTRUCTIONS APPLY TO THE FOLLOWING MODELS:

DA300201, DA300301, DA300401, DA300411, DL200101, DL200201, DL200311, DL200301 AND DA300501

# KAPTOR™ DROP PREVENTION RANGE

ANCHOR ATTACHMENTS | TOOL ATTACHMENTS | TOOL TETHERS

### APPLICATIONS:

TELECOMMUNICATIONS, MUNICIPALITIES, CONSTRUCTION, UTILITIES, ARBORISTS, OIL & GAS, PUBLIC SAFETY, SURVEY CREWS, RAILWAYS.



Barcode

THIS IS NOT A FALL ARREST EQUIPMENT.

KStrong LLC  
150 N. Radnor Chester Road, Suite F200  
Radnor, Pennsylvania 19087, United States  
Phone/Fax: 1-833-KSTRONG  
KStrong.com

USA BRAZIL ASIA

Please read and understand the manufacturer's instructions for each component or part of the complete system. Manufacturer's instructions must be followed for proper use, care, and maintenance of this product. These instructions must be retained and be kept available for the worker's reference at all times. Alterations or misuse of this product, or failure to follow instructions, may result in serious injury or death.

**Note:** The user is advised to keep this user instructions document for the life of the product.

Very often, the consequences of a falling object are underestimated:

- Dropping a work tool also means the risk of destroying the tool, and the possible damage to property can also have serious consequences in terms of costs, as well as the lost time required by the worker to leave their work station to recover the tool.
- The Kaptor™ range of tool lanyards are the perfect solution for drop prevention of tools while working at height.

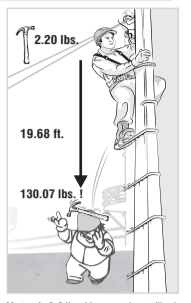

Note: A 2.2 lbs. Hammer hurts like it is 130 lbs. After falling from 19.68 ft. Refer to the illustration above.

**! Tool lanyards MUST NEVER be used for Fall Protection of any kind. Extreme caution must always be taken when operating or working near active machinery.**

This manual is as per ANSI/ISEA 121-2018 and must be read and understood in its entirety and used as part of a fall protection training program as required by OSHA or any state regulatory agency. The user must fully understand the proper equipment use and limitations.

Accordingly, the KStrong Kaptor™ range has been developed to hold any type of tool that may accidentally fall and cause damage to property, or serious injuries or even fatalities to workers. In fact, objects dropped by workers are the second largest cause of worker deaths in the workplace.

### WARNINGS

- Tool lanyards or similar products are never to be used as PPE.
- Never use any tool lanyards or its sub component beyond its capacity.
- Never modify or alter the product.
- Never tie a knot in the tool lanyards (including its sub systems)
- Be extra careful while using it around the moving machinery.
- There should always be an appropriate distance in order to avoid a dropped tool hitting other objects during its arrest.
- Always select the tools according to the capacity shown in in the technical specification table.
- **The use of these tool lanyards (that are not PPE) does not exempt you from the obligation of wearing PPE, especially a safety helmet.**

### ANCHOR ATTACHMENTS

These are secure anchor points that are used to attach to the objects / tools to prevent their drop while working.

### BEST SUITED FOR PEOPLE WORKING IN

Confined spaces and people working with tools on platforms and scaffoldings.

### TECHNICAL SPECIFICATIONS

Category	Product Name	Product Code	Rating	Length	Material
Anchor Attachment	Phone Holder	DA300201	5 lbs.	NA	Polyester
Anchor Attachment	Measuring Tape Holder	DA300301	2 lbs.	NA	Polyester, Steel
Anchor Attachment	Wristband Tool Holder	DA300401	2 lbs.	NA	Polyester, Steel
Anchor Attachment	Wristband Tool Lanyard	DA300411	2 lbs.	NA	Polyester, PP
Anchor Attachment	V-Ring Anchor Attachment	DL200101	35 lbs.	14"	Polyester, Steel
Anchor Attachment	V-Ring Anchor Attachment	DL200201	80 lbs.	24"	Polyester, Steel
Anchor Attachment	V-Ring Anchor Attachment	DL200311	35 lbs.	14"	Polyester, Steel
Anchor Attachment	V-Ring Anchor Attachment	DL200301	35 lbs.	14"	Polyester, Steel
Anchor Attachment	Drill Battery Holder	DA300501	11 lbs.	NA	Polyester, Steel

## KNOW YOUR ANCHOR ATTACHMENTS

### PHONE HOLDER



### MEASURING TAPE HOLDER



### WRIST BAND HOLDER



### V-RING ATTACHMENT

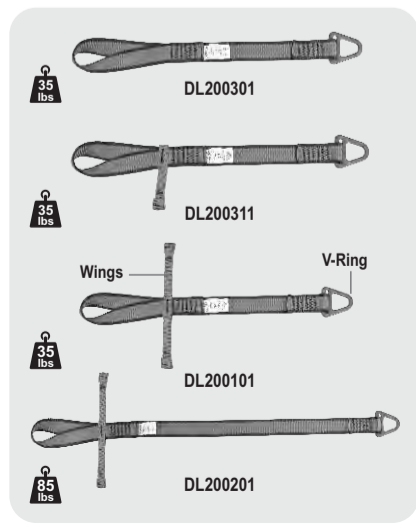

## STEPS TO USE PHONE HOLDER

For attaching to the Harness and Lanyard

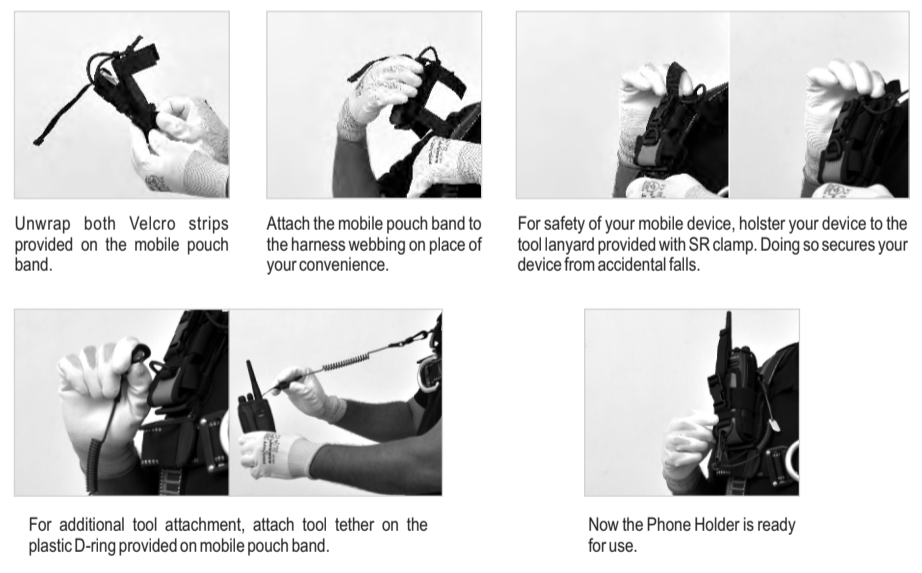

Unwrap both Velcro strips provided on the mobile pouch band.

Attach the mobile pouch band to the harness webbing on place of your convenience.

For safety of your mobile device, holster your device to the tool lanyard provided with SR clamp. Doing so secures your device from accidental falls.

For additional tool attachment, attach tool tether on the plastic D-ring provided on mobile pouch band.

Now the Phone Holder is ready for use.

## STEPS TO LOAD TAPE & USE THE MEASURING TAPE HOLDER

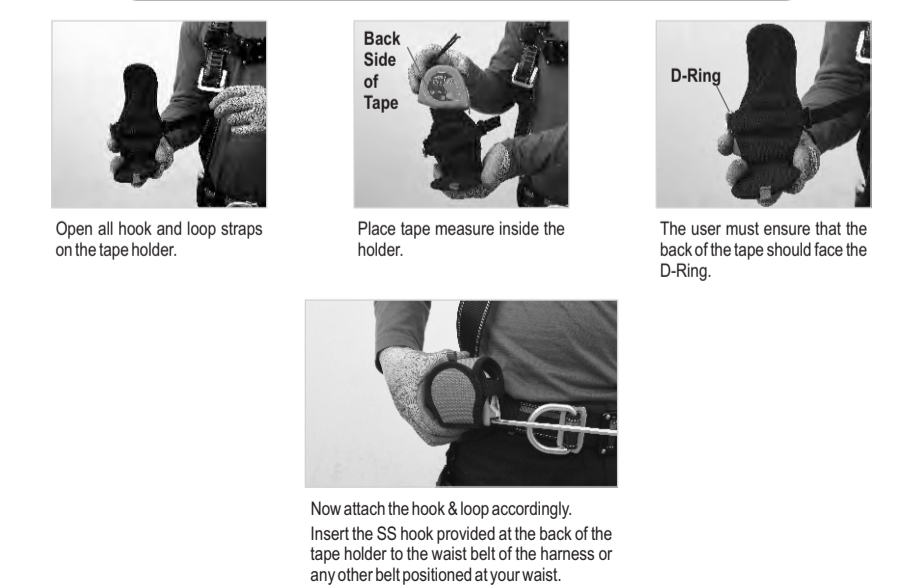

Open all hook and loop straps on the tape holder.

Back Side of Tape  
Place tape measure inside the holder.

D-Ring  
The user must ensure that the back of the tape should face the D-Ring.

Now attach the hook & loop accordingly. Insert the SS hook provided at the back of the harness or any other belt positioned at your waist.