



USER INSTRUCTION MANUAL

EDGE SINGLE POINT ANCHOR

THESE INSTRUCTIONS APPLY TO THE FOLLOWING MODEL:

AFA930001, AFA930001SS

EN 795:2012 Type A
TS 16415:2013 Type A

Please read and understand the manufacturer's instructions for each component or part of the complete system. Manufacturer's instructions must be followed for proper use, care, and maintenance of this product. These instructions must be retained and be kept available for the user's reference at all times. Alterations or misuse of this product, or failure to follow instructions, may result in serious injury or death.

Note: The user is advised to keep this user instructions document for the life of the product.

- 1. INTRODUCTION:** The Edge Single point anchor is classed as a Personnel Protective Equipment (PPE) by the European PPE Regulation (EU)2016/425 and has been shown to comply with this Regulation through the Harmonized European Standard EN 795:2012 type A and TS 16415:2013 Type A (for up to 4 users).

This Anchor is designed to minimize the risk of/provide protection against the danger of falling from heights. However, always remember that no item of PPE can provide full protection and care must always be taken while carrying out the risk related activity.

- 2. PERFORMANCE AND LIMITATIONS OF USE:**

The Anchor has been tested in accordance with EN 795:2012 type A and has achieved the following performance levels-

EN 795:2012 Type A test	Result/Comment
General Requirements for Anchor devices (Clause 4.2)	(PASS) No sharp edges (PASS).
Static Strength (Clause 4.4.1.3)	Sustained a force of 12 kN for 3 minutes (PASS).
Dynamic Strength & Integrity Test (Clause 4.4.1.2)	When tested with rigid steel mass of 100 kg, the test mass held after test with the device remaining stable throughout. (PASS) Anchor Holds an increased load of 300kg for 3 min following dynamic test.
Corrosion Resistance (Clause 4.7)	No corrosion evident after 48 hours of salt spray testing. (PASS)

TS16415:2013 Type A Test	Results
General Requirement Clause 4.1	Pass
Specific Requirement	
Static Strength Test Clause 4.2.1.2 Dynamic Strength and Integrity test Clause 4.2.1.1	Sustained a Static Load of 15kN (4 users) for 3 mins without failure Drop #01 Peak Force 8.6kN and Max Deflection 79mm Drop #02 Peak Force 7.3kN and Max Deflection 87mm Drop #03 Peak Force 6.4kN and Max Deflection 94mm Following Dynamic Test 900kg load sustained for 3 mins without failure

- 3. INSPECTION:** Visually inspect the system before each use to ensure that it is in a serviceable condition and is operating correctly. If during inspection, doubts are raised about the safety of the system or a component, these should be replaced either by the manufacturer or a competent person.

- 4. INSTRUCTIONS FOR USAGE :**

Single Point Anchor is to be used for anchorage in a fall arrest system. This anchor can be fixed to walls, ceilings, roof tops or steel structures present in the working environment.

- For Steel structures - drill one hole of dia 12.5mm in the steel structure (pass through) and bolt the anchor using one M 12 steel nut & bolt. Ensure that the nut & bolt is tightened.
- For Concrete Structures such as walls, ceiling and roof tops, ensure the concrete has a compression strength of at least 3000 PSI. Use one M12 chemical fastener to be fixed directly into the concrete structure. Refer Hilti fastener HVU installation guide.

The Anchor can be fixed so that the load impact is in any of the directions shown in the adjacent figure:-

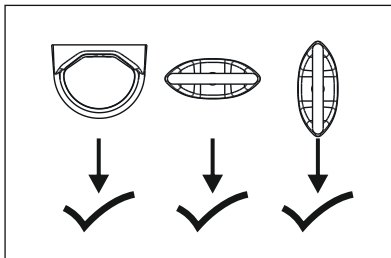

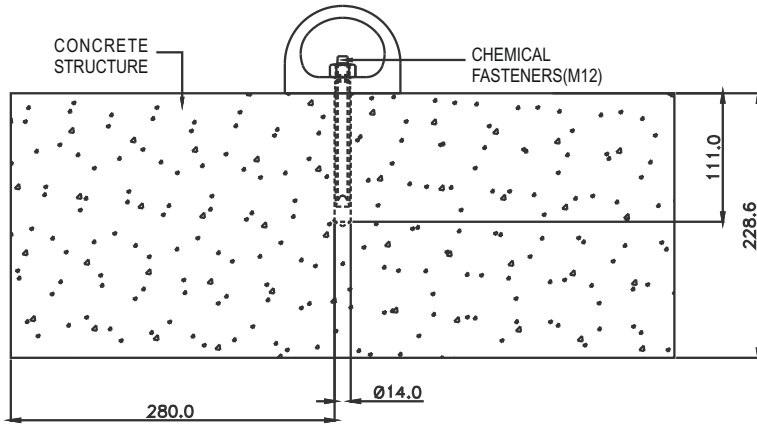

5. LIMITATIONS

- The Anchor should be the personal property of its user.
- It should not be used in highly acid or basic environment.
- The anchor has been tested to EN 795:2012 type A and is appropriate only for single person use with an energy absorber as per EN 355:2002.
- Ensure that the structure on to which the anchor is fitted is strong enough to withstand a load of 12kN. If unsure of structure strength, refer to an engineer.
- Ensure that the Anchor is installed directly above the user's head

6. COMPATIBILITY: To optimise protection, in some instance it may be necessary to use the anchor with suitable PPE such as: boots/ gloves/ helmet and ear protection. In this case, before carrying out the risk-related activity, consult your supplier to ensure that all your protective products are compatible and suitable for your application.

7. REPAIR: If the product becomes damaged, it will NOT provide the optimum level of protection, and therefore should be immediately removed from service. It needs to be inspected to see if it is replaced or repaired. Never use the damaged product. Repair is only permitted by the manufacturer or a nominated repair centre or individual approved by the manufacturer.

8. CLEANING: In case of minor soiling, wipe the anchor with cotton cloth or a soft brush. Do not use any abrasive material. For intensive cleaning wash the anchor in water at a temperature between 30°C to 60°C by using a neutral detergent (pH+7). The washing temperature should not exceed 60°C. Do not use acid or basic detergents.

9. STORAGE AND TRANSPORT: When not in use, store the anchor away from heavily acidic or basic environment. Never place heavy items on top of it. Also ensure that it is stored away from chemically hazardous environment preferably storage should be in dry environment.

10. WITHDRAWAL FROM USE: If the system has been used to arrest a fall, it should be removed from service and returned to the manufacturer or a competent repair centre for servicing and re test.

MARKING

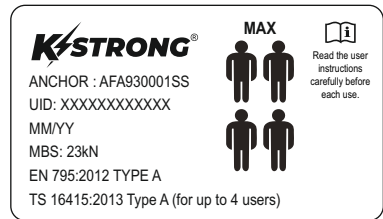
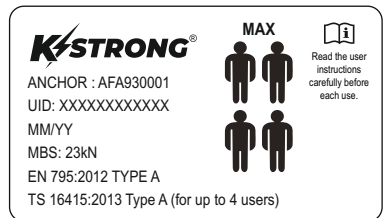

The Anchor is marked with :

- (i) Identification of the manufacturer
- (ii) Type or product code
- (iii) Product description
- (iv) UID
- (v) Compiled Norms

LIFESPAN: The estimated product Lifespan is 10 years from the date of manufacture. The following factors can reduce the Lifespan of the product: intense use, contact with chemical substances, specially aggressive environments, extreme temperature exposure, UV exposure, abrasions, cuts, violent impacts, bad use or maintenance.

DISCLAIMER: Prior to use, the end user must read and understand the manufacturer's instructions supplied with this product at the time of shipment and seek training from their employer's trained personnel on the proper usage of the product. Manufacturer is not liable or responsible for any loss, damage or injury caused or incurred by any person on grounds of improper usage or installation of this product.

EQUIPMENT RECORD				
Product				
Model & type/identification		Trade Name		Identification number
Manufacturer		Address		Tel, email into use
Year of manufacture		Purchase Date		Date first put into use
Other relevant information (eg. document number)				
PERIODIC EXAMINATION AND REPAIR HISTORY				
Date	Reason for entry (periodic examination or repair)	Defects noted, repairs carried out and other relevant information	Name and signature of competent person	Periodic examination next due date

Certification Body:

SATRA Technology Europe Ltd, Bracetown Business Park, Clonee, Dublin D15 YN2P Ireland (Notified Body 2777)

Ongoing Assessment Body:

SGS Fimko Oy, Takomotie 8, FI-00380 Helsinki, Finland (Notified Body 0598)

For EU Declaration, please visit <https://kstrong.com/asia/eu-declaration-form/>



KStrong Inc.
 150 N. Radnor Chester Road Suite F200
 Radnor, Pennsylvania 19087 United States
 Contact Email: customer-care@kstrong.com

www.kstrong.com

USA South America ASIA

AKS-AFA930001-181021-v2