



USER INSTRUCTION MANUAL

KTECH RESCUE/CLIMBING HELMET & VISOR

THESE INSTRUCTIONS APPLY TO THE FOLLOWING MODELS:

AHC101001R, AHC101001W, AHC101001O, AHC101002

CE 0598
EN 12492:2012
EN 166:2001

Please read and understand the manufacturer's instructions for each component or part of the complete system. Manufacturer's instructions must be followed for proper use, care, and maintenance of this product. These instructions must be retained and be kept available for the user's reference at all times. Alterations or misuse of this product, or failure to follow instructions, may result in serious injury or death.

Note: The user is advised to keep this user instructions document for the life of the product.

1. **INTRODUCTION:** The KTECH Rescue/Climbing Helmet is classed as Personal Protective Equipments (PPE's), and is a multi functional climbing helmet for working at heights and rescue operations. It complies with this Regulation through the Harmonized European Standard EN 12492 & EN166.
2. **INSTRUCTIONS:** A Rescue/Climbing Helmet is a piece of personal protective equipment, designed to minimize the risk of/provide protection for the user against the danger of falling from heights. It should be allocated to a single user (it can only be used by one person at a time). However, always remember that no item of PPE can provide full protection and care must always be taken while carrying out the risk related activity.
3. **PERFORMANCE AND LIMITATIONS OF USE:** This product has been tested in accordance with EN 12492:2012 & EN166:2001, and has achieved the following performance levels :

EN 12492:2012 test	Result/Comment
Impact / Shock Absorption Penetration Design Requirements Retention System	Achieves required performance requirement Achieves required performance requirement Achieves required performance requirement Achieves required performance requirement

4. PRODUCT DESCRIPTION:-

CODE	CATEGORY	DESCRIPTION	STANDARDS
AHC101001R	RESCUE/CLIMBING HELMET	KTECH RESCUE/CLIMBING HELMET (RED)	EN 12492:2012 & EN 166:2001
AHC101001W	RESCUE/CLIMBING HELMET	KTECH RESCUE/CLIMBING HELMET (WHITE)	EN 12492:2012 & EN 166:2001
AHC101001O	RESCUE/CLIMBING HELMET	KTECH RESCUE/CLIMBING HELMET (ORANGE)	EN 12492:2012 & EN 166:2001
AHC101002	RESCUE/CLIMBING HELMET	KTECH RESCUE/CLIMBING HELMET VISOR (CLEAR)	EN 166, EN 174

5. **MATERIAL USED:** Material used in the KTECH rescue/climbing helmet is PP, Polypropylene and nylon clips.

6. DONNING INSTRUCTIONS :

1. Before donning, rotate clockwise until the cradle is in its widest position- the adjustment dial on the back of the cradle anti

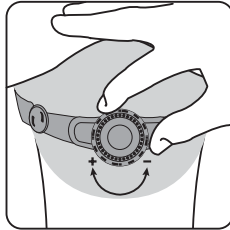

2. Put on the helmet and adjust the dial (clockwise to tighten, anticlockwise to loosen) until you obtain the desired fit.

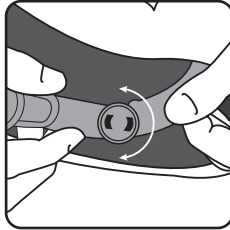

3. Position the back of the cradle in the nape of the neck, tilting it as required.

4. Fasten the chin strap by inserting one side of the buckle into the other, until you hear the locking mechanism click shut. Tug strap to ensure that the buckle is securely fastened.

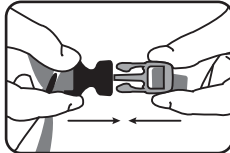

5. Adjust the length of the neck strap to fit the helmet securely to your head. Slide the strap loop to hold loose strap in place.

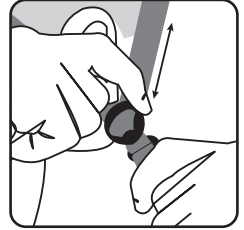

6. To position the chin strap correctly, adjust the chin strap positioners forward or back until they sit directly under your ears.

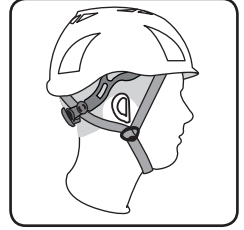

7. After properly buckling and adjusting the strap, check that the helmet is not excessively tight, does not move freely back and forth or side to side, and is well seated and centered on the head.

8. To remove the helmet, release the chin strap by squeezing together the tips of the male side of the snap buckle.

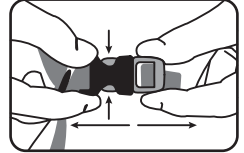
**VISOR OPERATIONAL INSTRUCTIONS :**

1. Use the thumb to push the lower edge of the visor downward gently. The visor will descend gradually from the up position automatically.



2. To stow, use the thumb and push the visor back up gently. The visor is now locked in its original position.



7. INSTRUCTIONS FOR USE:

This helmet must be worn at all times during work activity. For adequate protection, it is important that the helmet be sized correctly and fit the head properly to offer optimum comfort and safety.

The helmet should be adjusted to fit the user; for example, the straps should be positioned so that they do not cover the ears, the buckle should be kept away from the jawbone, and the straps and buckle should be adjusted so that they are comfortable and secure.

After properly buckling and adjusting the strap, always check that the helmet is not excessively tight, does not move freely back and forth or side to side, and is well seated and centered on the head (see Fig. 1). The less the helmet can move, the better protection it will provide.

Before donning, rotate the adjustment dial on the back of the cradle anticlockwise until the cradle is in its widest position.

Put on the helmet and adjust the dial (clockwise to tighten, anticlockwise to loosen) until you obtain the desired fit (Fig. 2).

Position the back of the cradle in the nape of the neck, tilting it as required (Fig. 3).

Fasten the chin strap by inserting one side of the buckle into the other, until you hear the locking mechanism click shut (Fig. 4). Tug strap to ensure that the buckle is securely fastened.

Adjust the length of the neck strap to fit the helmet securely to your head. Slide the strap loop to hold loose strap in place.

To position the chin strap correctly, adjust the chin strap positioners forward or back until they sit directly under your ears (Fig. 5).

To remove the helmet, release the chin strap by squeezing together the tips of the male side of the snap buckle (Fig. 6).

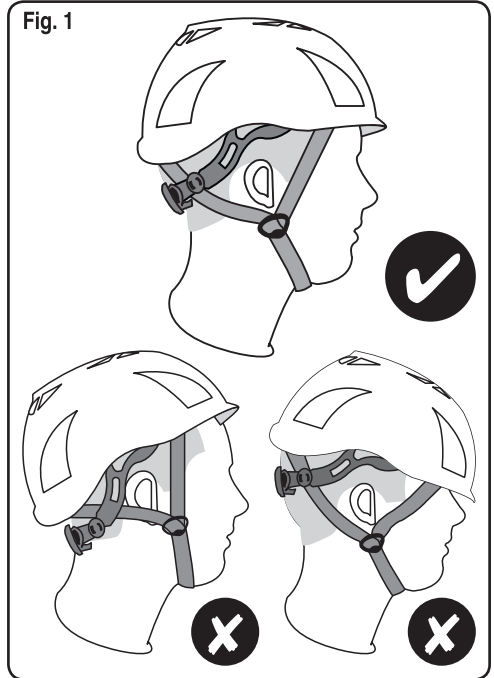

Fig. 2

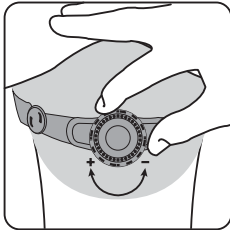

Fig. 3

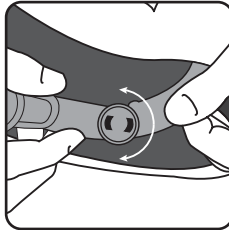

Fig. 4

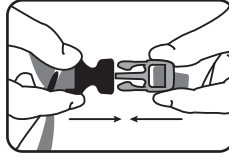

Fig. 5

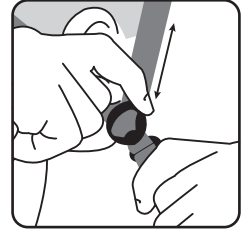
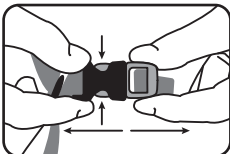
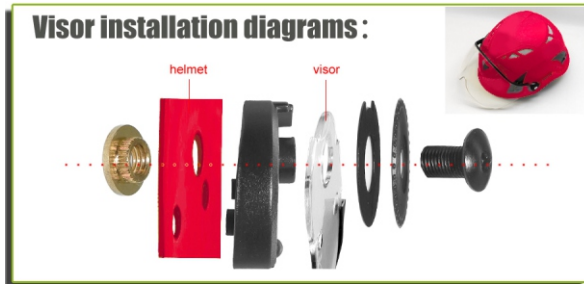

Fig. 6



8. VISOR ASSEMBLY INSTRUCTIONS:

1. Place all parts and screws at ready position



2. Insert the golden nut into the shell from the inner side of helmet



3. Insert the bigger piece into the side of the helmet



4. Place the visor onto the helmet



5. Place the slice part unto the helmet



6. Put the black cap on and bolt into the helmet

**9. HELMET EAR MUFF FITTING INSTRUCTIONS:**

1. Insert clip of ear muff assembly into exterior slot on side of helmet and snap into place. Repeat for opposite side.



9. CLEANING AND STORAGE INSTRUCTIONS:

CLEANING: Clean the helmet only with water, neutral pH soap, and a soft, clean cloth, allowing it to air dry at room temperature. The removable cradle lining can be hand- or machine-washed in cold water (max. 30°C - 85°F). In no case should chemical detergents or solvents be used.

STORAGE: When not in use, the helmet should be stored away from direct sunlight and sources of heat. We recommend storing it in the original packaging.

TRANSPORT: During transport do not pack the helmet too tightly.

10. MODIFICATIONS, PARTS, & ACCESSORIES:

REPLACEMENT PARTS: If necessary, contact the dealer or contact the manufacturer directly. None of the original components of the helmet may be changed and/or removed without the manufacturer's approval. The helmet should not be modified to attach any unapproved accessories.

ACCESSORIES: Check with the dealer or manufacturer what accessories are available. If they are supplied with the helmet, follow the mounting instructions that come with the accessory. Only accessories approved by the manufacturer should be used.

MODIFICATIONS AND REPAIRS: Do not apply adhesives, solvents, stickers or paint that does not comply with the manufacturer's specifications. Do not modify the helmet in any way unless the modifications are specifically authorized by AURORA. An unauthorized modification can reduce the product's effectiveness and invalidate its certification. Repairs made outside of AURORA facilities are prohibited.

11. WARNINGS

Carefully read and understand these instructions. Use this helmet exclusively for the activities for which it is certified and in strict accordance with all applicable OSH regulations.

Improper use of this helmet can cause serious or fatal injury. If the instructions are not followed correctly, the level of protection offered by the helmet can be significantly reduced. Inspect the helmet before every use for any signs of visible damage. **DO NOT USE HELMET AFTER IT HAS SUSTAINED A MAJOR IMPACT OR IF YOU ARE UNSURE OF ITS CONDITION.**

The user must familiarise themselves with all features, capabilities and limitations of the helmet, and receive specific instructions and/or training from a competent and responsible person in the proper use of the helmet.

Activities involving the use of this equipment are inherently dangerous. You are responsible for your own actions and decisions. Before using this equipment, you must:

- read and understand all instructions for use;
- get specific training in its proper use;
- become acquainted with its capabilities and limitations;
- understand and accept the risks involved.

12. PRODUCT LIFE:

The actual lifetime of a product ends when it meets one of the retirement criteria listed below (see "When to retire your equipment"), or when it is judged obsolete (see "Product Obsolescence"). The actual lifetime is influenced by a variety of factors such as the intensity, frequency, and environment of use, the competence of the user, how well the product is stored and maintained, etc.

ATTENTION: in extreme cases, the lifetime of the product can be reduced to one single use through exposure to, for example, any of the following: chemicals, extreme temperatures, sharp edges, major fall or load, etc. Inspect the helmet regularly to check for any damage! Cracks, detached parts, warping, flaking, and changes in colour are significant signs of the helmet's state of deterioration; Regardless of apparent condition, we advise replacing the helmet after 5 years, because its ability to protect decreases over time due to the aging of the materials. The manufacturing date is shown on the inside of the helmet.

13. PRODUCT INSPECTION:

Inspect equipment periodically for damage and/or deterioration. If you find any minor cuts, abrasions, or other visible damage, make sure the helmet is subject to a detailed inspection before further use. In addition to the inspection before and during use, a periodic in-depth inspection must be carried out by a competent inspector at least once every 12 months. The frequency of the in-depth inspection must be governed by the type and the intensity of use. To keep better track of your equipment, it is preferable to assign each piece of equipment to a unique user so that he/she will know its history.

The results of inspections should be documented in an "inspection record". This document must allow recording of the following details:

- type of equipment;
- model and ID number (eg. serial number);
- name and contact details of manufacturer or distributor;
- year of manufacture, date of purchase, and date of first use;
- name of user;
- all other pertinent information such as maintenance history and frequency of use;
- a history of periodic inspections (including date, comments and noted problems, plus the name and signature of the competent person who performed the inspection).

When To Retire Your Equipment:

Immediately retire any equipment if:

- it fails to pass inspection (including inspection before and during use and the periodic in-depth inspection);
 - it has been subjected to a major fall or load;
 - you do not know its full usage history;
 - it is more than 5 years old;
 - you have any doubt as to its structural integrity.
- Destroy retired equipment to prevent further use.

LIFESPAN: The estimated product Lifespan is 10 years from the date of manufacture. The following factors can reduce the Lifespan of the product: intense use, contact with chemical substances, specially aggressive environments, extreme temperature exposure, UV exposure, abrasions, cuts, violent impacts, bad use or maintenance.

DISCLAIMER: Prior to use, the end user must read and understand the manufacturer's instructions supplied with this product at the time of shipment and seek training from their employer's trained personnel on the proper usage of the product. Manufacturer is not liable or responsible for any loss, damage or injury caused or incurred by any person on grounds of improper usage or installation of this product.

EQUIPMENT RECORD				
Product				
Model & type/identification		Trade Name		Identification number
Manufacturer		Address		Tel, email into use
Year of manufacture		Purchase Date		Date first put into use
Other relevant information (eg. document number)				
PERIODIC EXAMINATION AND REPAIR HISTORY				
Date	Reason for entry (periodic examination or repair)	Defects noted, repairs carried out and other relevant information	Name and signature of competent person	Periodic examination next due date

Certification Body :

SATRA Technology Europe Ltd, Bracetown Business Park, Clonee, Dublin D15 YN2P Ireland (Notified Body 2777)

Ongoing Assessment Body:

SGS Fimko Oy, Takomotie 8, FI-00380 Helsinki, Finland (Notified Body 0598)

For EU Declaration, please visit <https://kstrong.com/asia/eu-declaration-form/>



KStrong Asia Pte Ltd
33A Chander Road,
Singapore 219539

Contact Email: customer-care@kstrong.com

www.kstrong.com

USA

South America

Asia
