

# DOUBLE PULLEY WITH DOUBLE SIDE ATTACHMENT

AFX206002

## Features

- Double Aluminum anchorage pulley, light weight, movable side/middle plates which allows quick installation.
- Double anchorage pulleys allow to achieve mechanical advantages.
- Pulley is large enough to accommodate rope up to 16 mm diameter
- Attachment Point can accommodate a connector up to 16 mm diameter

## How To Use

Refer to User Instruction Manual



## Metal Components

Material	:	Aluminum Alloy (Body) Stainless Steel (Sheaves)
Finish	:	Anodized (Body) Polished (Sheaves)
Minimum Breaking Strength	:	40 kN

## Weight

810.5 gm ± 20 gm

## Relevant Standards

EN 12278:2007

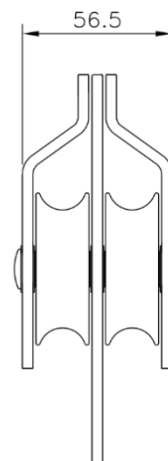
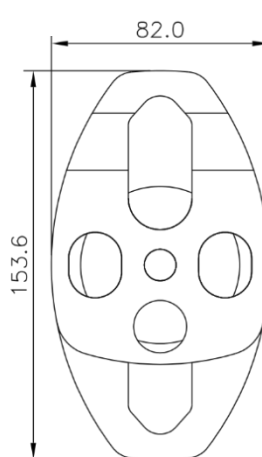

CE 0598

EN 80079-36:2016  
EN 80079-37:2016



II 2G E<sub>x</sub> h II, T6 G<sub>b</sub>