

INTERMEDIATE CLAMPING PLATES FOR BEAM FLANGE

AFA935851(L)

Features

- Clamping plates designed to be fixed on metal I BEAM as intermediate Connection.
- The widths of base have an adjustable opening to adopt to the type of Beam section.
- Compatible with Intermediate AFF111510

How To Use

Refer to User Instruction Manual



Metal Components

Clamping Plates	:	Alloy Steel: ED Coated Black
Bolts	:	M10 A40/70 316 Stainless Steel
System Strength	:	23 kN

Flange Width

Minimum Flange Width Compatibility	:	150.0 mm
Maximum Flange Width Compatibility	:	389.0 mm

Weight

6.83 kg + 0.05 kg

Relevant Standards

EN 795:2012 Type A, TS 16415:2013 Type A

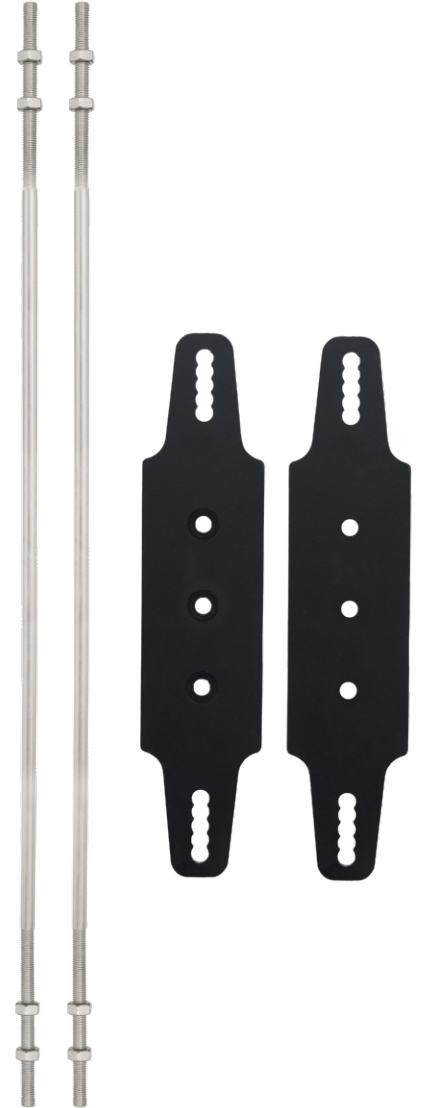
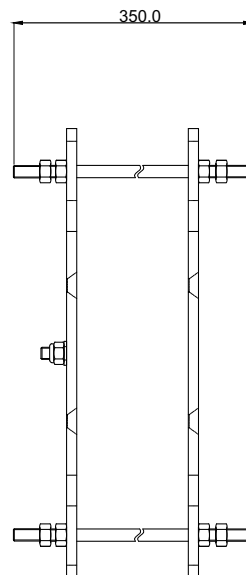
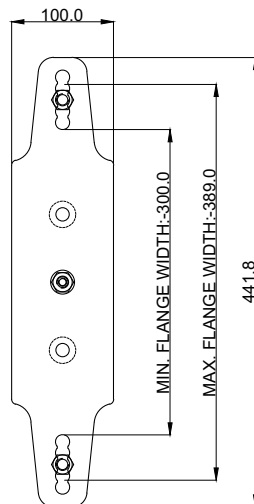

CE 0598