

UNIVERSAL EXTREMITY CLAMPING PLATES FOR BEAM FLANGE

AFA935801(L)

Features

- Anchor plate is designed to be fixed on metal I BEAM as an extremity post.
- The width of the base have adjustable opening to adopt type of Beam section.
- Compatible with Extremity Plate AFF113710

How To Use

Refer to User Instruction Manual

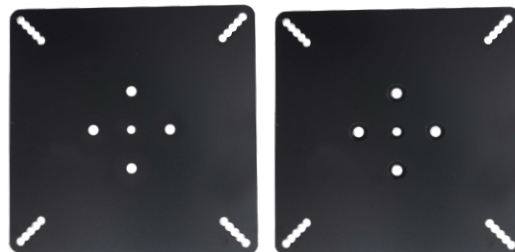

Metal Components

Clamping Plates	:	Alloy Steel: ED Coated Black
Bolts	:	M12 A4/70 316 Stainless Steel
System Strength	:	23 kN

Flange Width

Minimum Flange Width Compatibility	:	150.0 mm
Maximum Flange Width Compatibility	:	372.0 mm

Weight

28.58 kg ± 0.05 kg

Relevant Standards

Conforms to EN 795:2012 Type A

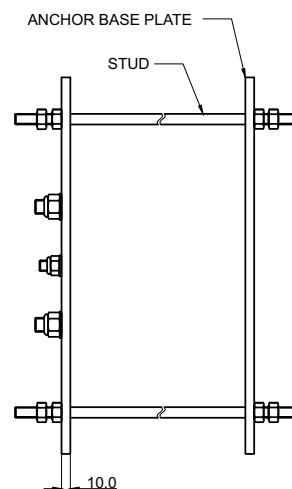
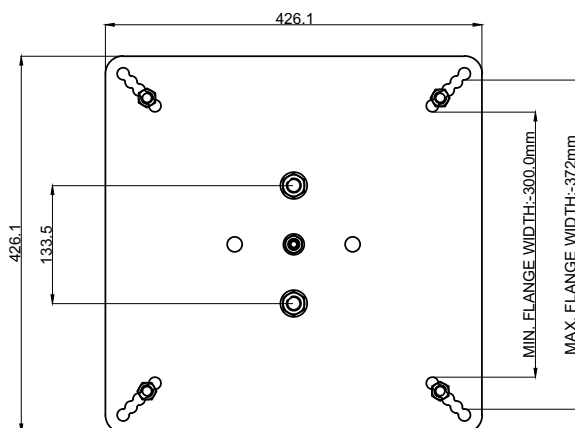

CE 0598